

AMPHENOL PART NUMBER CONFIGURATION  
**UE86-3G6620-X0X61**

- LIGHT PIPE OPTION**
- 0 - NO LIGHT PIPE
  - 1 - 4 LP PER 2X1, NORMAL ORIENTATION
  - 2 - 2 INNER LP PER 2X1, NORMAL ORIENTATION
  - 3 - 2 OUTER LP PER 2X1, NORMAL ORIENTATION
  - 4 - 4 LP PER 2X1, REVERSING ORIENTATION
  - 5 - 2 INNER LP PER 2X1, REVERSING ORIENTATION
  - 6 - 2 OUTER LP PER 2X1, REVERSING ORIENTATION
  - 7 - 3 LP PER 2X1, 2 OUTER LP, NORMAL ORIENTATION
  - 8 - 3 LP PER 2X1, 2 OUTER LP, REVERSING ORIENTATION

- PACKAGING**
- T - TRAY PACKAGING (STACKED)
- PLATING OPTIONS FOR CONNECTOR**
- 2 - 30µ" GOLD PLATING ON MATING AREA
  - 15 - 100µ" MATTE TIN ON TERMINATION
  - 3 - 30µ" GOLD PLATING ON MATING AREA
  - 150 - 300µ" MATTE TIN ON TERMINATION
  - 5 - 15µ" GOLD PLATING ON MATING AREA
  - 15 - 100µ" MATTE TIN ON TERMINATION
  - 6 - 15µ" GOLD PLATING ON MATING AREA
  - 150 - 300µ" MATTE TIN ON TERMINATION

REVISIONS				
REV.	ECN	DESCRIPTION	DATE	APPROVED
C		UPDATE NOTES	AUG 19/14	J.SI
D		CHANGED PCB THICKNESS	NOV 03/15	J.SI
E		REMOVED DIM. ZONE B4, SHEET 2 OF 5	OCT 31/16	J.SI

PART NUMBER  
 (LAST DIGIT INDICATING  
 PACKAGING TYPE, NOT  
 PRINTED ON THE PART)

DATE CODE

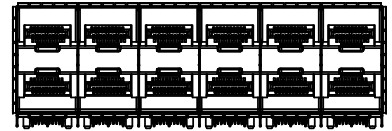
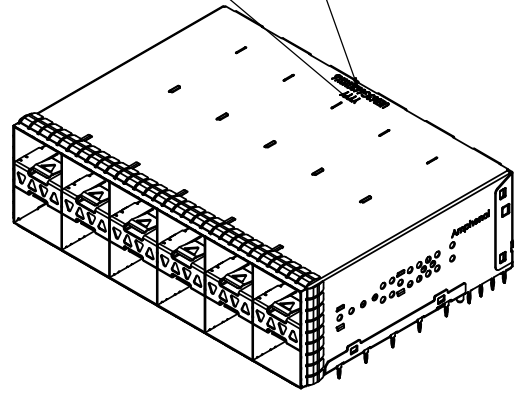

NO LIGHT PIPES  
 UE86-3G6620-00361

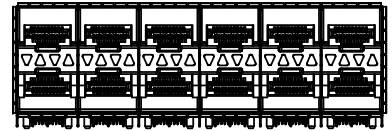

4 LIGHT PIPES  
 UE86-3G6620-10361

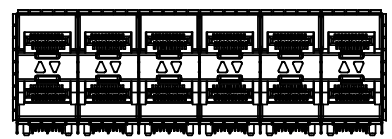

2 INNER LIGHT PIPES  
 UE86-3G6620-20361

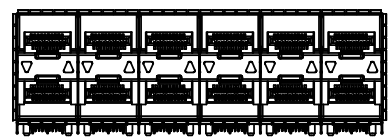

2 OUTER LIGHT PIPES  
 UE86-3G6620-30361

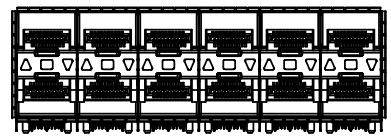

3 LIGHT PIPES UPSIDE DOWN  
 UE86-3G6620-80361

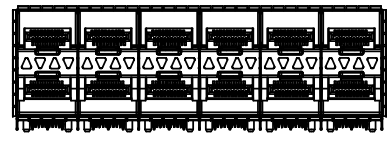

4 LIGHT PIPES UPSIDE DOWN  
 UE86-3G6620-40361

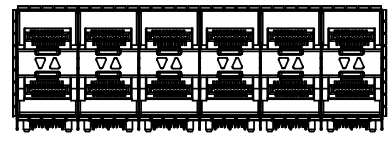

2 INNER LIGHT PIPES UPSIDE DOWN  
 UE86-3G6620-50361

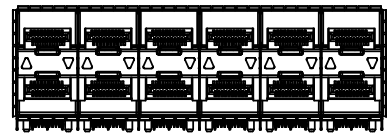

2 OUTER LIGHT PIPES UPSIDE DOWN  
 UE86-3G6620-60361

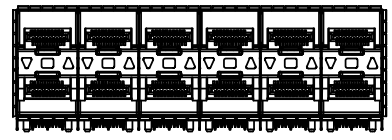

3 LIGHT PIPES  
 UE86-3G6620-70361

MATERIAL: (RoHS COMPLIANT)

1. CAGE - PRESS FIT: COPPER ALLOY (NICKEL SILVER)
2. CONNECTOR - PRESS FIT:  
 - PLASTIC HOUSING: LCP, FLAMMABILITY RATING UL94-V0  
 - CONTACTS: PHOSPHOR BRONZE
3. LIGHT PIPE: CLEAR POLYCARBONATE, FLAMMABILITY RATING UL94-V0
4. PACKAGING: TRAY PACKAGING
5. TEMPERATURE RANGE: -40°C TO +85°C



THIS DOCUMENT CONTAINS PROPRIETARY INFORMATION AND SUCH INFORMATION MAY NOT BE DISCLOSED TO OTHERS FOR ANY PURPOSE OR USED FOR MANUFACTURING PURPOSES WITHOUT WRITTEN PERMISSION FROM AMPHENOL CANADA CORP.

UNLESS SPECIFIED OTHERWISE	DRAWN	P. OU	FEB10/14
DIMENSIONS ARE IN MILLIMETERS	CHECKED	J. SI	NOV03/15
REFERENCE IN PARENTHESES	M.E. APP'D		
GENERAL TOLERANCES	Q.A. APP'D		
1 DECIMAL PLACE ±0.25	DWG APP'D	J. SI	NOV03/15
2 DECIMAL PLACE ±0.15	MATERIAL AND FINISH	SEE NOTES	
3 DECIMAL PLACE N/A	REF.	ECN Exxxxx	
ANGULAR DEGREES ±1°	THIRD ANGLE PROJECTION	DO NOT SCALE DRAWING	
ENG. REL. NO.			

<b>Amphenol High Speed Interconnects</b> A Division of Amphenol Corp. www.amphenolcanada.com			
2X6 SFP ULTRAPORT WITH LIGHT PIPE OPTIONS AND EMI SPRING FINGER			
DWG. NO.	P-UE86-3G6620-X0X61		REV E
CODE ID NO.	03554	DWG SIZE: A4	SCALE: 2:3 SHEET 1 OF 5

**REVISIONS**

REV.	ECN	DESCRIPTION	DATE	APPROVED
C		UPDATE NOTES	AUG 19/14	J.SI
D		CHANGED PCB THICKNESS	NOV 03/15	J.SI
E		REMOVED DIM. ZONE B4, SHEET 2 OF 5	OCT 31/16	J.SI

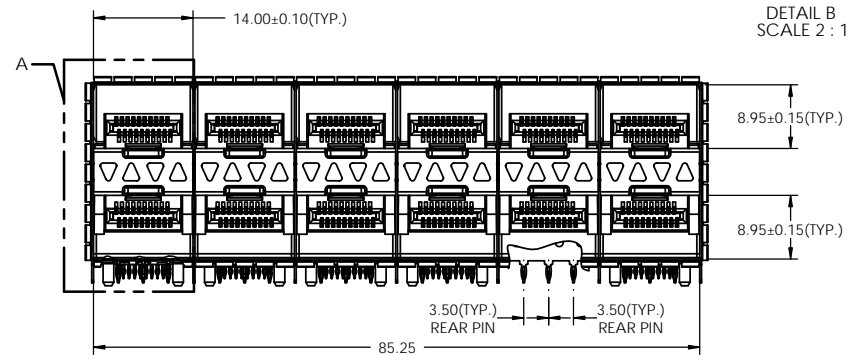
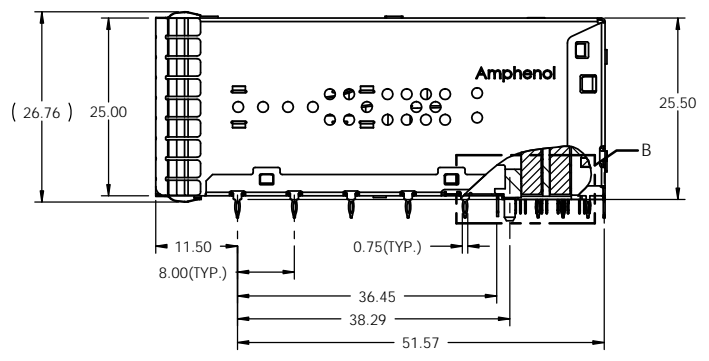
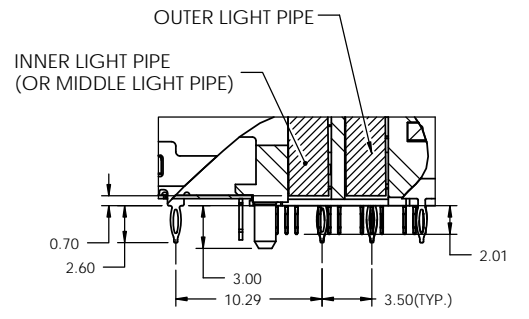
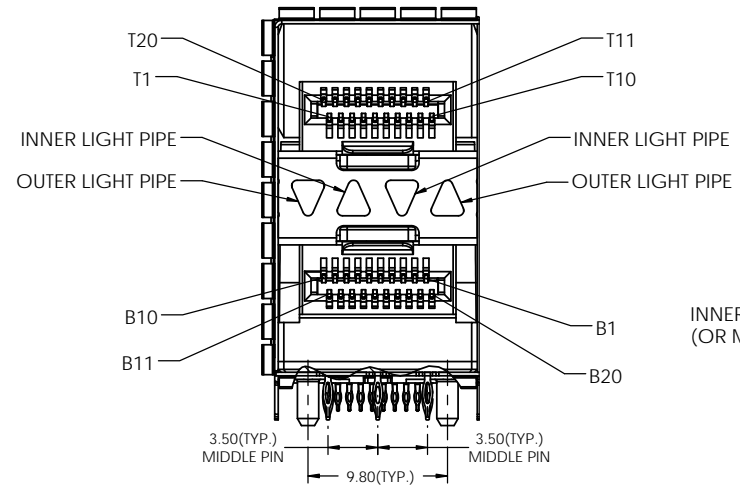
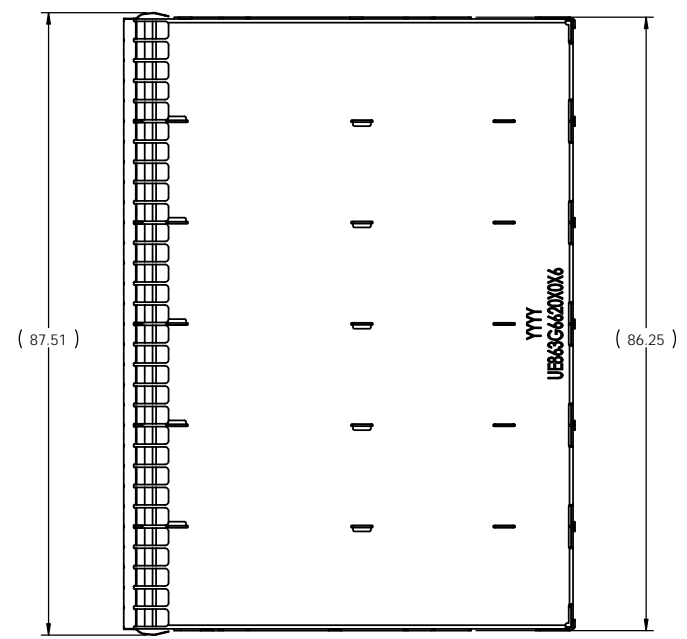

THIS DOCUMENT CONTAINS PROPRIETARY INFORMATION AND SUCH INFORMATION MAY NOT BE DISCLOSED TO OTHERS FOR ANY PURPOSE OR USED FOR MANUFACTURING PURPOSES WITHOUT WRITTEN PERMISSION FROM AMPHENOL CANADA CORP.

UNLESS SPECIFIED OTHERWISE DIMENSIONS ARE IN MILLIMETERS REFERENCE IN PARENTHESES GENERAL TOLERANCES 1 DECIMAL PLACE ±0.25 2 DECIMAL PLACE ±0.15 3 DECIMAL PLACE N/A ANGULAR DEGREES ±1° ENG. REL. NO.	DRAWN	P. OU	FEB10/14	<b>Amphenol High Speed Interconnects</b> A Division of Amphenol Corp. www.amphenolcanada.com  <b>2X6 SFP ULTRAPORT WITH LIGHT PIPE                  OPTIONS AND EMI SPRING FINGER</b>	DWG. NO. P-UE86-3G6620-X0X61 CODE ID NO. 03554 DWG SIZE: A4 SCALE: 1:1 SHEET 2 OF 5
	CHECKED	J. SI	NOV03/15		
	M.E. APP'D				
	Q.A. APP'D				
	DWG APP'D	J. SI	NOV03/15		
	MATERIAL AND FINISH	SEE NOTES			
	REF.	ECN Exxxxx			
	THIRD ANGLE PROJECTION				
	DO NOT SCALE DRAWING				

1 2 3 4 5 6

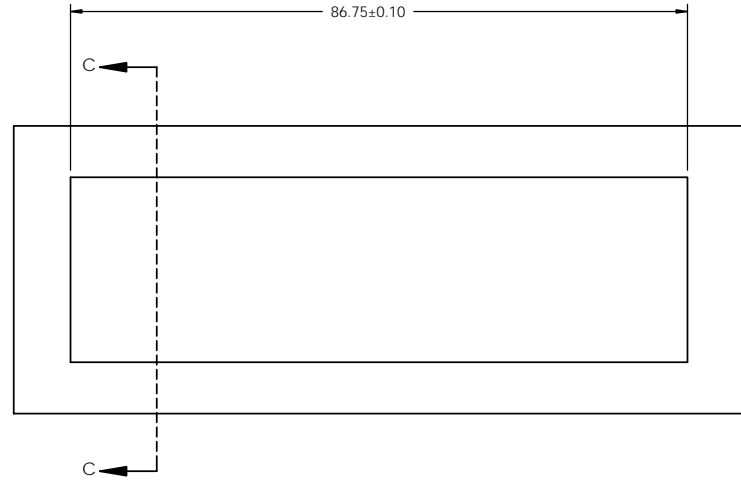

REVISIONS				
REV.	ECN	DESCRIPTION	DATE	APPROVED
C		UPDATE NOTES	AUG 19/14	J.SI
D		CHANGED PCB THICKNESS	NOV 03/15	J.SI
E		REMOVED DIM. ZONE B4, SHEET 2 OF 5	OCT 31/16	J.SI

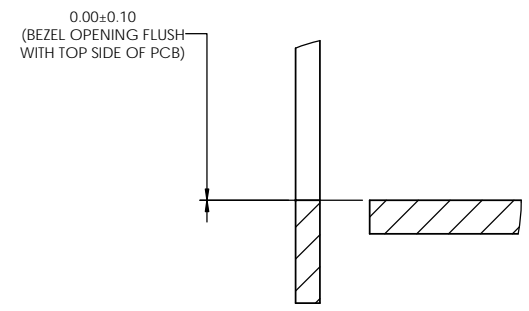
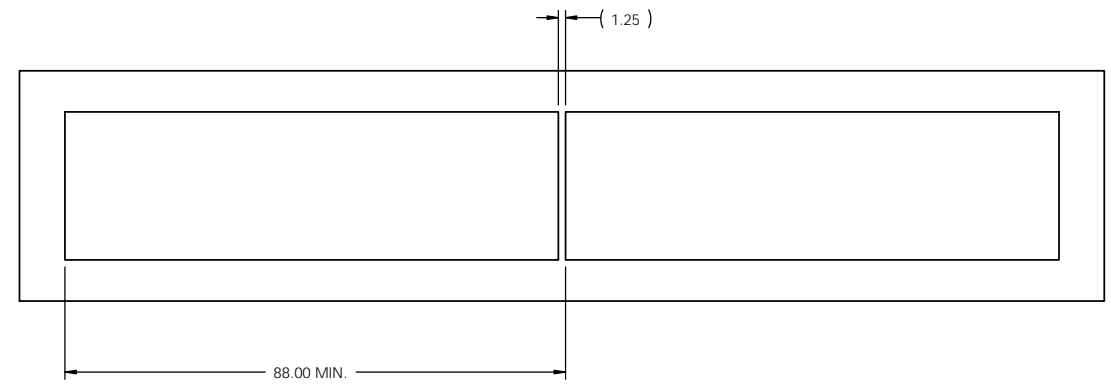
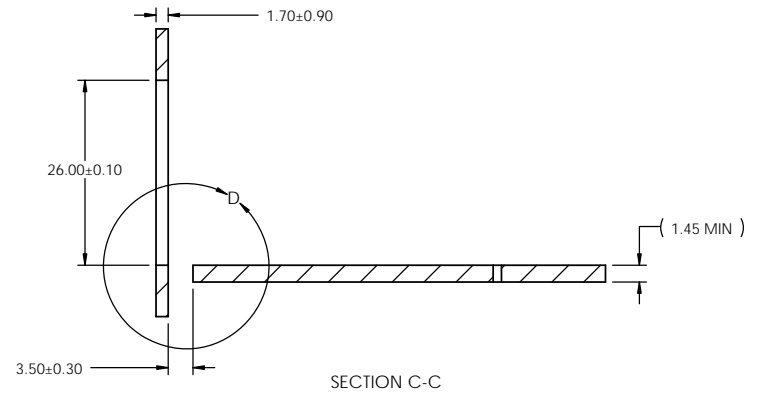

DETAIL D  
SCALE 2 : 1

THIS DOCUMENT CONTAINS PROPRIETARY INFORMATION AND SUCH INFORMATION MAY NOT BE DISCLOSED TO OTHERS FOR ANY PURPOSE OR USED FOR MANUFACTURING PURPOSES WITHOUT WRITTEN PERMISSION FROM AMPHENOL CANADA CORP.

UNLESS SPECIFIED OTHERWISE		DRAWN	P. OU	FEB10/14	<b>Amphenol High Speed Interconnects</b> A Division of Amphenol Corp. www.amphenolcanada.com  <b>2X6 SFP ULTRAPORT WITH LIGHT PIPE OPTIONS AND EMI SPRING FINGER</b>
DIMENSIONS ARE IN MILLIMETERS		CHECKED	J. SI	NOV03/15	
REFERENCE IN PARENTHESES		M.E. APP'D			
GENERAL TOLERANCES		Q.A. APP'D			
1 DECIMAL PLACE	±0.25	DWG APP'D	J. SI	NOV03/15	
2 DECIMAL PLACE	±0.15	MATERIAL AND FINISH	SEE NOTES		
3 DECIMAL PLACE	N/A	REF.	ECN Exxxxx		
ANGULAR DEGREES	±1°	THIRD ANGLE PROJECTION	DO NOT SCALE DRAWING		DWG. NO.
ENG. REL. NO.					P-UE86-3G6620-X0X61
					CODE ID NO. 03554   DWG SIZE: A4   SCALE: 1:1   SHEET 3 OF 5

1 2 3 4 5 6

1 2 3 4 5 6

REVISIONS				
REV.	ECN	DESCRIPTION	DATE	APPROVED
C		UPDATE NOTES	AUG 19/14	J.SI
D		CHANGED PCB THICKNESS	NOV 03/15	J.SI
E		REMOVED DIM. ZONE B4, SHEET 2 OF 5	OCT 31/16	J.SI

A  
B  
C  
D

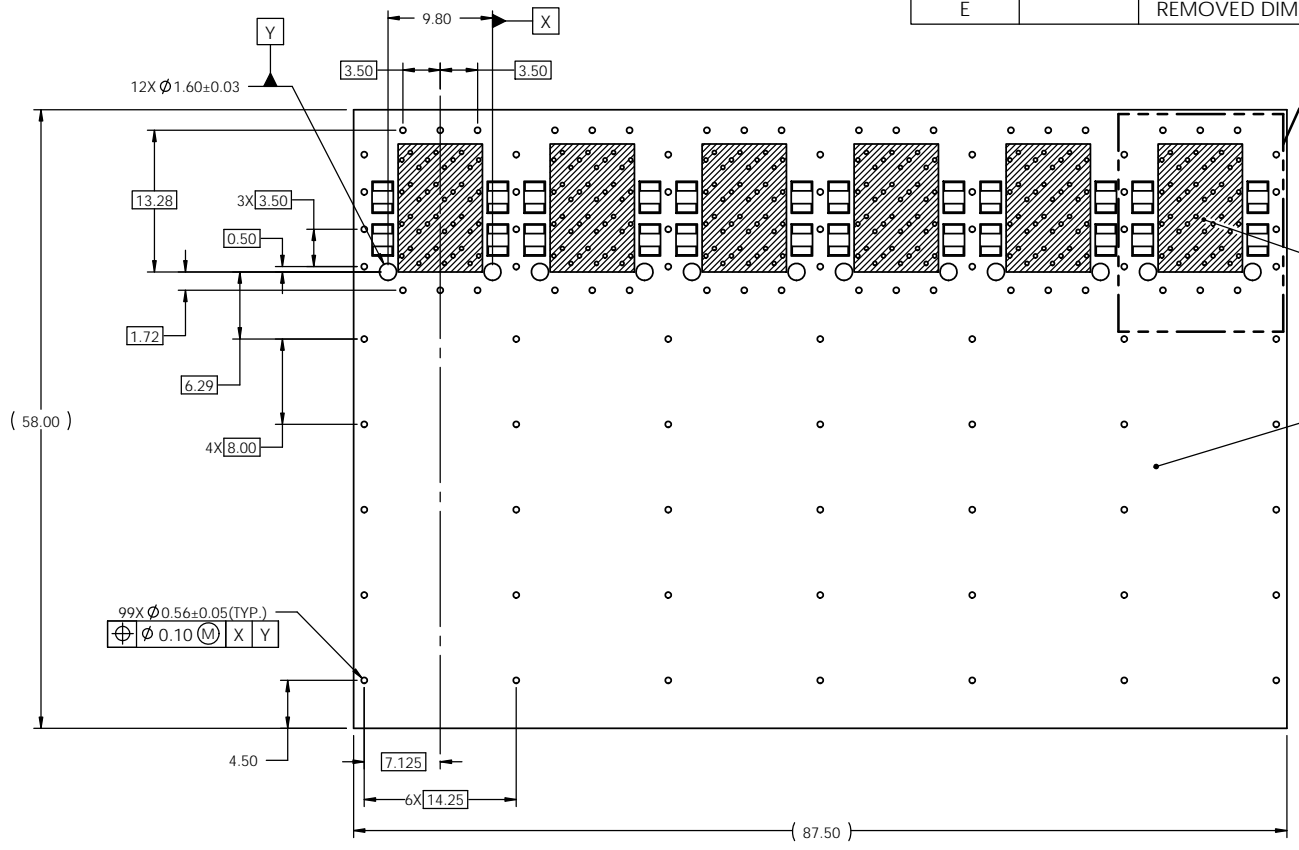

NOTES:  
1. 0.56 mm DIAMETER HOLES ARE CHASSIS GROUND (99HOLES).

COMPONENT KEEP-OUT AREAS

COMPONENT KEEP-OUT AREAS

**2X6 PCB LAYOUT**

THIS DOCUMENT CONTAINS PROPRIETARY INFORMATION AND SUCH INFORMATION MAY NOT BE DISCLOSED TO OTHERS FOR ANY PURPOSE OR USED FOR MANUFACTURING PURPOSES WITHOUT WRITTEN PERMISSION FROM AMPHENOL CANADA CORP.

UNLESS SPECIFIED OTHERWISE	DRAWN	P. OU	FEB10/14	<b>Amphenol High Speed Interconnects</b> A Division of Amphenol Corp. www.amphenolcanada.com  <b>2X6 SFP ULTRAPORT WITH LIGHT PIPE OPTIONS AND EMI SPRING FINGER</b>	DWG. NO. P-UE86-3G6620-X0X61 REV E
DIMENSIONS ARE IN MILLIMETERS	CHECKED	J. SI	NOV03/15		
REFERENCE IN PARENTHESES	M.E. APP'D				
GENERAL TOLERANCES	Q.A. APP'D				
1 DECIMAL PLACE $\pm 0.25$	DWG APP'D	J. SI	NOV03/15		
2 DECIMAL PLACE $\pm 0.15$	MATERIAL AND FINISH	SEE NOTES			
3 DECIMAL PLACE N/A	REF.	ECN Exxxxx			
ANGULAR DEGREES $\pm 1^\circ$	THIRD ANGLE PROJECTION				
ENG. REL. NO.				DO NOT SCALE DRAWING	

1 2 3 4 5 6

REVISIONS				
REV.	ECN	DESCRIPTION	DATE	APPROVED
C		UPDATE NOTES	AUG 19/14	J.SI
D		CHANGED PCB THICKNESS	NOV 03/15	J.SI
E		REMOVED DIM. ZONE B4, SHEET 2 OF 5	OCT 31/16	J.SI

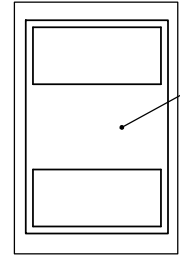
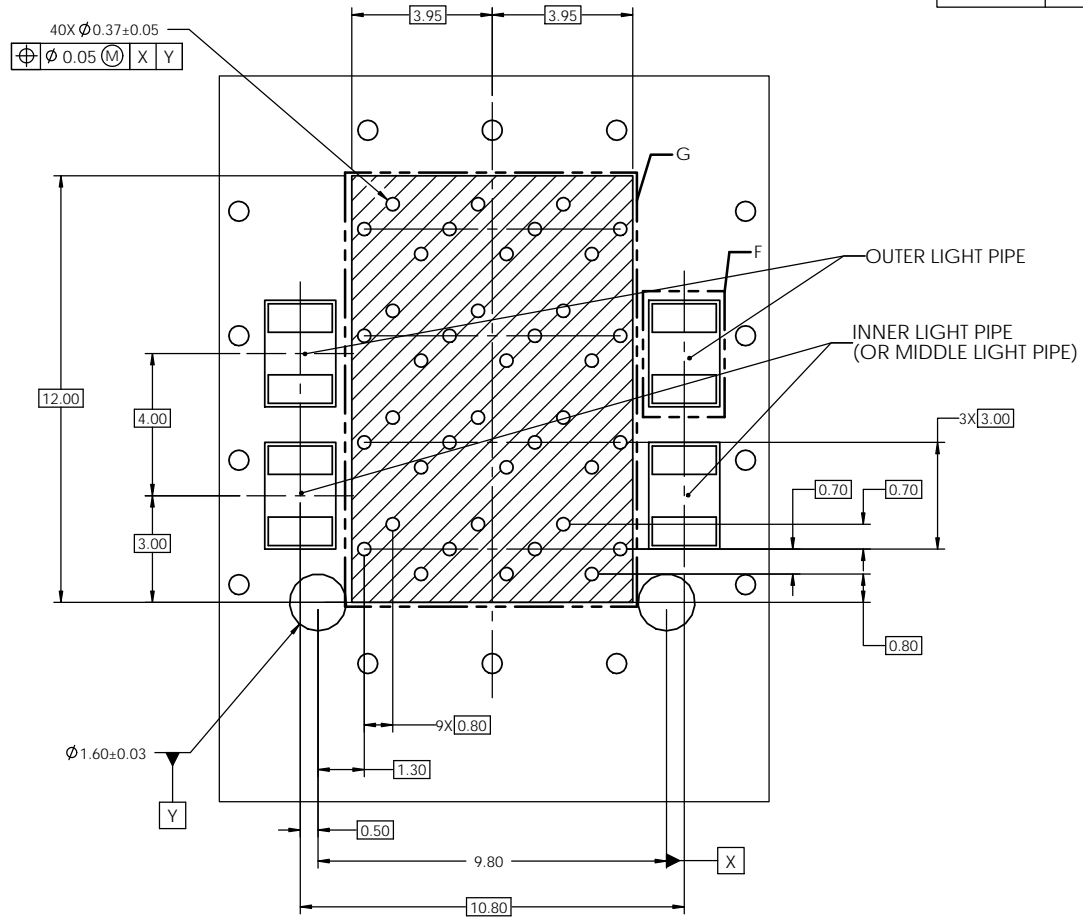

DETAIL F  
SCALE 10 : 1

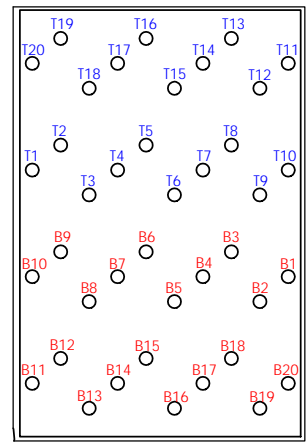

DETAIL G  
SCALE 5 : 1

DETAIL E  
SCALE 5 : 1

THIS DOCUMENT CONTAINS PROPRIETARY INFORMATION AND SUCH INFORMATION MAY NOT BE DISCLOSED TO OTHERS FOR ANY PURPOSE OR USED FOR MANUFACTURING PURPOSES WITHOUT WRITTEN PERMISSION FROM AMPHENOL CANADA CORP.

UNLESS SPECIFIED OTHERWISE DIMENSIONS ARE IN MILLIMETERS REFERENCE IN PARENTHESES GENERAL TOLERANCES 1 DECIMAL PLACE ±0.25 2 DECIMAL PLACE ±0.15 3 DECIMAL PLACE N/A ANGULAR DEGREES ±1° ENG. REL. NO.	DRAWN	P. OU	FEB10/14	<b>Amphenol High Speed Interconnects</b> A Division of Amphenol Corp. www.amphenolcanada.com  <b>2X6 SFP ULTRAPORT WITH LIGHT PIPE          OPTIONS AND EMI SPRING FINGER</b>	DWG. NO. <b>P-UE86-3G6620-X0X61</b>	REV <b>E</b>
	CHECKED	J. SI	NOV03/15			
	M.E. APP'D					
	Q.A. APP'D					
	DWG APP'D	J. SI	NOV03/15			
	MATERIAL AND FINISH	SEE NOTES				
	REF.	ECN Exxxxx				
	THIRD ANGLE PROJECTION					
	DO NOT SCALE DRAWING					
	CODE ID NO.	03554	DWG SIZE: A4	SCALE: 2:1	SHEET 5 OF 5	